



AUSTRALIA'S MOST AWARDED LUXURY BOAT BUILDER



445 SUV | THE ULTIMATE RIVIERA



## TWO BOATS ... IN ONE

The sporty and adventurous Riviera SUV series opens up a whole new world of boating enjoyment for both the avid angler and cruising entertainer.

Indeed, our valued owners tell us it's a lot like having two boats ... in one.

The very spacious SUV series is the perfect pairing of two legendary designs, each with its own formidable pedigree ... and while its name has automotive origins, this very versatile range of Riviera has been created with the 'ultimate boating experience' foremost in mind.

The result, of course, is a collection of crossover vessels like no other – one which combines the high-performance, blue-water cruising and fish-raising abilities of the classic Riviera Flybridge, and the single-level, leisurely entertaining features of our very popular Sport Yacht design.

The Riviera SUV series truly is ... the best of both worlds.

## A NEW ALFRESCO ERA

The 445 SUV has a special place in the heart of Riviera. You see, she was the first model released under our new SUV banner ... and we are immensely proud of this very versatile example of Riviera's enduring design refinement.

So much so that we reserved her the very special privilege of being our 5000th Riviera.

The SUV series, and especially the 445, reflects the diversity of ways in which Riviera owners use their vessels – information gleaned from owner forums around the world inspires us to continually fine-tune our concepts and designs ... and sometimes our entire attitude.

The 445 SUV, we admit, is actually your idea – she is extremely capable of serving the needs of the serious sport-fisher, as well as those of the consummate entertainer. She is the ultimate passage-maker and even the perfect home away from home for the cruising couple, affording extended living aboard, with room for guests and without pining for any shore-side comforts.









The SUV series of Riviera retains all the distinctive indoor/outdoor characteristics for which our iconic boats are internationally renowned – clever and convenient alfresco lifestyle concepts, ultramodern technology, luxurious appointments ... not to mention excellent serviceability, savvy storage and an exacting eye for detail right through from fit to finish.

Befitting a pleasure craft of this calibre, the 445's brilliant design puts to purpose every inch of available space and offers myriad lifestyle options so owners can truly personalise their boat. You immediately sense this multi-faceted approach from the moment you step aboard – the multitude of choices to customise your 445 puts her in a class of her own.

The solid GRP swim platform, which comes with ladder, lid and grab rail, can be teak-laid and even widened to serve as an extension of the cockpit floor space. The strong GRP transom storage centre can be customised with a live bait tank, complete with circulating pump, as well as a bait preparation station, sink and mixer tap under a lift-up lid.

Or, if you prefer, you can install an alfresco BBQ console with electric grill and LED lighting, again with sink and hot and cold water – to ensure you make the most of her expansive cockpit and its potential alfresco lifestyle delights ... the choice is yours.

You'll discover many hidden treasures as you inspect the floor of the 445's no-nonsense, Flybridge-styled GRP cockpit, which instinctively drains to the stern and can be teak-laid or carpeted, depending on your preference. Two massive, side self-draining storage lockers with heavy duty stainless steel lockdowns and gas struts keep tackle, toys and furniture dry and out of sight, or can serve as deep fish bins with pump-out facilities to keep the evening's dinner fresh ... out of the elements and ready for preparation. You'll also notice toe-kicks and smart storage for ropes and fenders in







the coaming, as well as fresh and saltwater wash-down facilities – also cleverly located out of sight, yet right at hand when you need them.

Optional heavy-duty stainless steel rod-holders can also be fitted, along with outriggers and padded bolsters – and there's a reinforced alloy plate in the cockpit floor for a game chair or outdoor dining table. Again, these sorts of decisions are best left to you ... and your specific boating requirements.

The sleek, low-profile GRP hardtop of the 445 extends out and over the cockpit and owners can extend this even further with a stainless steel and acrylic canvas awning for further protection from the sun and extremities.

On the mezzanine there's a comfortable two-seater lounge to starboard – perfect for taking in all the fishing action, or a sunset, or simply to view the rapidly-vanishing wake of this 47-foot boat on-song at full throttle. Under the lounge is more savvy storage and to port is a solid surface bench-top with top-loading refrigerated cool box, ice-maker and self-draining recycling bin.

Wide side decks with well-placed hand rails port and starboard lead to the forward deck, where an optional white vinyl-covered sun-pad provides the perfect place to enjoy a cool sunset drink, or to just relax at anchor with a good book.



## THIS IS THE LIFE

Stepping into the saloon of the 445's luxurious living area, you'll be immediately taken with the sheer volume of her interior and the inspiring sense of light and space enhanced, in part, by the fact her rear bulkhead is tinted, tempered glass.

From the aft port-side galley, a large awning window opens out and over the cockpit, in effect bringing the entire rear of the boat inside and accentuating a free-flowing feel from the windscreen through to the swim platform. This functional feature is evidence of Riviera's willingness to listen to the way owners use their boats .. and affirms the chef's space as the conductor's podium of the social scene .

Of course, it also makes enormous sense – you don't all go to the galley to prepare a meal, all go to sit at the dinette to eat, all go to the lounge to watch TV or all head out to the cockpit for fishing or BBQ time. In the real world, many (or all) of these activities may be happening at the same time, and do, often in the glorious chaos of many guests. Hence, the 445 is the multi-tasking vessel for today's lifestyle afloat.

The modern and functional U-shaped galley, aft and just to port of the main pedestrian thoroughfare, resembles a contemporary display kitchen with a dual-element cooktop with removable pot-keepers, premium brand microwave convection oven, exhaust fan as well as dual Vitrefrigo drawer refrigeration, and an optional dishwasher.

The lighting overhead is energy-saving LED, and the solid surface bench-top comes in a range of finishes to complement the elegantly striking cabinetry of satin-varnished oak and teak, or high-gloss cherry.







## YOU'LL FEEL RIGHT AT HOME

The 445 SUV's large and luxurious living area helps you feel right at home, with panoramic, tinted opening side windows capturing fresh sea breezes and bringing even more light into the saloon. This is complemented by two overhead hatches, each of which have flyscreens and sliding block-out shades.

The premium quality furnishings – soft-touch leathers and plush fabrics – are enriched by practical living features, for example, the large U-shaped premium leather lounge which seats 6 envelopes a hi-lo dining table which folds and lowers to become a coffee table or, optionally, also a bed should you desire.

Overhead, the saloon headlining is padded and finished in leatherette, and a highly polished stainless, recessed elliptical handrail runs through the centre for added stability.

From every saloon seating position you can view the 445's 32-inch LED TV, which folds up from the starboard-side dash – conveniently keeping it out of the way when not in use but ensuring it can be easily accessed when required. The TV is integrated with an audio/DVD entertainment system with iPod interface and subwoofer, also cleverly stored out of sight, and connected to four speakers in the saloon as well as two remote speakers in the cockpit.

1. The cockpit features a large bench top protected by the hardtop overhang that will be appreciated when entertaining as it can act as a bar or food servery. Beneath the bench top is storage space and rubbish bin, icemaker and lift top fridge. The mezzanine features a two drawer unit beneath the lounge. 2. The saloon table can be lowered to create additional sleeping accommodation or a massive chaise lounge. The table has two outside leaves that fold into the centre to covert it from dining to coffee table.



## OPULENT ACCOMMODATION

Riviera's steadfast commitment to going "first-class" in everything it does extends to the flexible two stateroom/two-bathroom accommodation deck of the 445 SUV – again there's absolutely no compromise in terms of on-board liveability and luxury for the cruising couple.

Natural light filters into the wide accommodation atrium, complemented by non-slip, high-quality natural timber-finish flooring in the companionway, where stainless steel brush strips protect the step edges and courtesy mood lighting leads the way to the generous-sized staterooms.

The forward master stateroom, with its own private entrance, is in itself a complete and comfortable retreat for when privacy is preferred. Here, a contemporary palette of elegant fabric, soft-touch leatherette and satin oak with teak accents add a touch of aesthetic elegance, and also serve to dampen noise.

Sleek, sweeping hull windows bring in natural light, while fresh air is captured by an overhead deck hatch with Oceanair block-out screen.

The master's queen-sized walk-around bed with innerspring mattress is supremely comfortable. There are drawers underneath the bed as well as side tables for convenience, plenty of cedar-lined hanging space to keep garments crease-free and fresh, and also savvy storage cabinets with mirrored doors and positive locking hardware. The headlining is padded and upholstered, while LED mood lighting sets the scene for an enjoyable night. If desired, an optional 22 LED TV/DVD can be fitted in the master.

A private ensuite to port boasts a contemporary and elegant finish to the master suite, a reminder that the 445 is no less than a world-class Riviera. An overhead deck hatch, also with block-out screen, assists with the flow of fresh air here and a contemporary high-end finish, including solid surface vanity bench-top and porcelain sink with mixer, completes the job.







## ABSOLUTE COMFORT

The 445's versatility extends to the full-beam guest stateroom aft, which can sleep up to three adults in absolute comfort. Full-sized single beds with storage underneath slide across to form an island, queen-sized bed if preferred, and there's an additional single bed to starboard. Large framed feature mirrors are fitted to the aft bulkhead, reflecting an abundance of light captured by the 445's large hull windows on both sides, while fresh air fills the room through opening portholes with alarms that will sound if they are left open. There is an optional entertainment package for this stateroom too.

Of course, the premium-finish philosophy also applies to the VIP guest ensuite, which doubles as a dayhead. A clever two-way door creates privacy for guests, who will be impressed by the consistency of Riviera's exacting eye for detail and luxurious appointments throughout. An additional overhead deck hatch, also with Oceanair block-out screen, has a dual purpose of allowing extra fresh air and light to filter in.

1. Master stateroom ensuite
2. Guest bathroom / dayhead



## STEP INTO THE FUTURE

The stylish and sophisticated command centre of Riviera's 445 UV is testament to its superior and savvy design elements, and provides even more evidence that there's "no compromise" in any area of this versatile vessel.

An elevated, sports-styled helm console has a distinct automotive feel and complementing a huge array of ultramodern marine technology are two large and luxurious low-back leather helm seats, each with arm and footrests.

Here is another indication that Riviera's in-house team of award-winning designers and engineers have listened to owners: thoughtfully placed drink-holders and moulded recesses secure mobile phones and storage for equipment covers.

Of course, all critical navigation electronics, comprehensive engine instrumentation and vessel controls are within easy and ergonomic sight and reach of the skipper's helm chair to port, including the sports steering wheel, two large display screens, anchor chain counter and, of course, the helm joystick to port, and within fall of hand.

Look out through the expansive, curved and toughened glass windscreen you will start to appreciate the thought that has gone into designing the 445 – there are three heavy-duty pantograph windscreen wipers, as well as freshwater washers to ensure optimum visibility in all weather.







## PERFECT PACKAGE

Having now built over 400 pod-driven luxury pleasure boats, Riviera is at the forefront of a marine revolution. Indeed, we've seen the future ... and it faces forward.

Preferred power in the 445 SUV is the new-generation and fuel-efficient twin Volvo IPS2 600 – D6 diesel engines (320kW / 2 x 435hp) with pod propulsion units, featuring forward-facing, counter-rotating propellers.

This new generation IPS2 pod propulsion system offers the benefits of the innovative and responsive joystick for slow-speed manoeuvrability and precise docking. Indeed a skipper – either solo or with a novice crew – can simply push and twist the joystick in the required direction to make the boat respond immediately, pivoting in place or crabbing sideways into a berth that's just long enough to fit the vessel. In the 445, there is an optional joystick on the port-side of the cockpit, should you desire.

Quiet operation of the 445 is achieved through under-water exhausts, an effective silencer, state-of-the-art turbocharger and an air filter with improved insulation. At the same time, the robust engine design, which has a commercial rating of 5 for high-speed planing craft, contributes to minimising on-board vibrations.

In addition to all of the above, IPS2 also offers excellent power-to-weight ratio, impressive fuel efficiency, long cruising range and high top-end speed. The 445 with twin Volvo IPS2-600s achieves a top speed of over 32 knots under full load, a cruising speed of over 26.5 knots and a cruising range of 335nm at 26 knots, with 10 per cent fuel reserve.

IPS2 also offers Dynamic Positioning System for station-holding while waiting over a school of bait fish, while preparing lines and fenders or while waiting off a fuel jetty, and there's an optional upgrade to Volvo's state-of-the-art Glass Cockpit, which raises the bar in terms centralised control of navigation equipment, engine and alarms.





## C-ZONE CONVENIENCE

The Riviera 445 SUV is equipped with the cutting-edge CZone digital switching system that makes it easier than ever to stay well informed and in full control of your boat ... so you can concentrate on enjoying it.

Unlike traditional electrical systems, CZone enables you to control power equipment such as lights, pumps and navigation electronics when and how desired. Dimmers, relays, timers and extensive cable harnesses are also integrated into the system. For instance, one can dim lights, use real time system clocks for alarm setting and logical blocks (If X happens, then Y occurs), or set parameters for products to monitor wear and tear or anomalies.

At the push of a button – either at the touch-screen control panel in the saloon or through your iPad – the boat's system can be transformed from "Dock Mode" to "Cruise Mode" to easily prepare for a day at sea. There's also "Entertain Mode" to get the party started as well as "Service Mode", which shuts down all power and systems. The CZone displays are extremely intuitive to use, with simple controls and a menu structure that is easy to follow.

## DRY WHERE IT COUNTS

The "no compromise" approach is certainly evident in the flow-coated engine room, gained through a hatch with gas struts and steel lockdowns at the mezzanine step at the entrance to the saloon, thoughtfully opening forward to enhance passenger safety.

And when it comes to servicing the 445's pods and engines, the entire cockpit floor can be raised hydraulically to provide direct access to the engine room – yet another example of the practicality of her unique design.

Here in the engine room you'll also notice that, where possible, every wire, loom and plumbing line is coded, coloured, numbered and saddled neatly to ensure easy access for servicing. Additionally, each hot and cold fresh water line is able to be individually isolated and bypassed should there be any unforeseen issues.

You'll also notice that all through-hull fittings have ball valves and are double hose-clamped on or below the water line, and that the GRP 2000L (528 US gallons) fuel tank has both sight and electronic gauges. Each engine also has high-quality fuel filters, with an option for dual filters. Emergency fuel shut-off valves can be accessed from outside the engine room for added safety, via the fuel manifold located on the top

of the fuel tank and accessed via a hatch in the galley floor.

Acoustic and thermal insulation linings are also key features, as is the impressive commercial air intake system helping to keep the engine room temperature at 10 degrees less than the maximum recommended by the engine manufacturer, and thus helping to reduce fuel consumption even further. The optional air-conditioning units are mounted high so gravity feeds all condensation water through the common drain lines, while a mist elimination system with veins draw additional moisture from the air.

Four automatic bilge pumps with manual override are located at various points throughout the hull and pump out directly, as opposed to the common drain lines located on either side of the boat that drain aft, reducing the number of hull skin fittings required.

## ELECTRICAL EXCELLENCE

The 445's maintenance-free batteries ensure carefree boating and are housed in special battery boxes in accordance with American Boating and Yacht Council standards.

The boat also includes individual start battery banks for increased reliability with emergency parallel function. All battery banks are individually isolated at the main battery panel located in the cockpit, providing peace of mind in the unlikely event that one engine shuts down.

Watching television while at anchor is whisper-quiet through the on-board DC-AC inverter for all installed televisions, entertainment systems and ice-maker. The 445's Onan's 9.5/11.5 Quiet Diesel generator has self-monitoring capability and network communication and features state-of-the-art diagnostics. Sound shields minimise noise and deliver better sound quality, while an optimised mounting system greatly reduces vibration.

LED lights are used throughout the 445 to provide trouble-free boating and reduce electrical current draw. The lamps use less than 10 per cent of the power required to run a bulb lamp – no bulbs mean no maintenance ... and long service life.





## IMPECCABLE PEDIGREE

The 445 is, in all respects, a true embodiment of Riviera heritage. By this we mean all the familiar – and reassuring – aspects of classic Riviera boat-building are there: the purposeful lines, the hefty scantlings, the solid feel in a seaway, the spatial sense, the layout and the sumptuous décor, as well as an expansive, Flybridge-scale cockpit.

The SUV's confident offshore poise comes, to a large degree, from Riviera's leading CAD technology and legendary build quality that combine super-strong hand layups with solid GRP bottom and structural core material on the hull flanks, main deck and hardtop, as well as precisely fitted lightweight resin transfer mouldings pre-fitted for a perfect seal when all major components are bonded together.

A great deal of our acumen regarding hull shape has contributed to, for example, aft chine strakes that have a straight run to enhance both speed and manoeuvrability, as well as a moderate Vee shape going forward to a precise deadrise of 14.5 degrees at the transom to stay beautifully composed in a choppy quarter sea without diminishing top-end performance.

However, even before a single piece of timber was cut for the plug work, the 445 was created in-house using industry-leading Unigraphics 3D computer software, allowing Riviera's team of talented and passionate international designers and engineers to put to purpose every inch of available space, with a firm focus on convenient access to every key maintenance point so any issues can be quickly identified and addressed, and service costs are kept to a minimum.

Of course, this thoughtful consideration for our Riviera family of owners is a key part of our 'built to last' philosophy that allows our owners years and decades of confident and enjoyable boating.

We call it ... 'the ultimate boating experience'!





Optional barbeque and teak deck



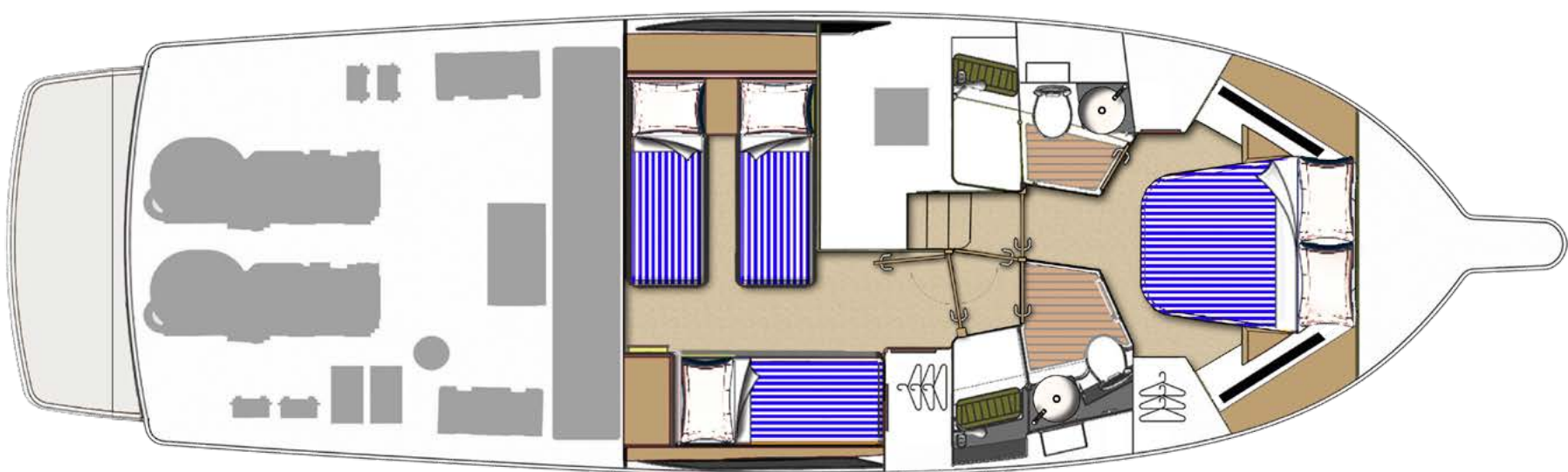



## CRAFTED WITH PASSION

Riviera is an Australian success story and a major international marketer of luxury pleasure boats. Our growth over more than 34 years has resulted in a company that today creates and manufactures three individual model collections and supports an international dealer network that spans more than 60 countries. We are also Australia's most awarded pleasure boat manufacturer.

The secret of our success is an absolute commitment to quality. Be it our 400 strong team of people, our work practices, materials, tools and technology, environmental responsibility or after sales service, we are rigorous in pursuing the highest standards.

Our craftspeople consult world-leading naval architects, engineers and designers. Our employment and training practices have also earned us many local and national awards.

Riviera operate the largest luxury boat building facility in the Southern Hemisphere and boasts some of the most sophisticated technology available.

# 34 YEARS OF RIVIERA

SINCE 1980

Our PASSION  
To create the *ultimate* boating experience.

I ♥ RIV

## AWARDED FOR EXCELLENCE

Riviera's vast collection of industry awards is a reflection of the pride and passion our master craftsmen put into every model in our premium range of Australian-built luxury pleasure craft.







The home of Riviera. The 14 hectare state-of-the-art manufacturing facility on the Gold Coast in Queensland. This is the largest facility of its kind in the Southern hemisphere.



## RIVIERA'S ETHOS INSPIRES CONFIDENCE

The quality of our service is commensurate with the quality of our boats and is something we are passionate about. The experience of purchasing your Riviera, from the selection of the electronics and décor, to the regular service and maintenance will all be carried out reliably, promptly and smoothly. In fact, you can count on us, and our global dealer network, for the life of your boat.

It is this consistent quality that has created Riviera's enormous and ever-growing international appeal.

Today there are over 5000 Riviera luxury boats located in all corners of the globe.

A sensational and growing choice of models, an impeccable pedigree, excellent value and outstanding service: now more than ever, Riviera's reputation for quality with integrity inspires confidence in boating enthusiasts the world over.







The growing Riviera global network of dealers now spans 60 countries. Find a dealer near you at [RivieraAustralia.com](http://RivieraAustralia.com)







ELECTRONICS

Electronics play an ever-increasing role in the pleasure, performance and safety of luxury boats, and the choice of equipment that is available today is vast. In fact, selecting the equipment that meets your needs can be a very challenging task. R Electronics is here to help: we source the best systems and products from around the world, we are experts at matching technology to individual requirements and work closely with Riviera's design team and Riviera's global Dealer Network to create systems that maximise your pleasure and safety.

[RElectronics.com.au](http://RElectronics.com.au)



GENUINE PARTS | ACCESSORIES

A passion for quality and good design steers everything we do at Riviera – and that is reflected in our exclusive range of clothing, accessories and decor items. If you love your Riviera, you'll feel at home with the Riviera Collection: casual yet stylish, comfortable, practical and made to withstand the rigours of boating life.

The Accessory and Decor Collection ranges from a storm jacket to stylish crockery. Riviera has the total leisure and style solution.

To make your boat truly your own, we offer a wide choice of fabrics, finishes and color schemes that allow you to customise your Riviera. Of course, we also have experienced designers who can advise and assist with your individual selection.

It is a real pleasure to own and use things that are aesthetically pleasing, work well and last – and because it is only appropriate that such qualities are found on board a Riviera, we supervise each individual interior scheme from creation to installation.

[RivieraParts.com.au](http://RivieraParts.com.au)







## THE RIVIERA EXPERIENCE

When you buy a Riviera, you are really joining a family.

Indeed, this "Riviera Experience" is something we take very seriously and value very highly – we believe our core duty is to help owners of our world-class, Australian-built luxury pleasure craft to achieve the ultimate boating experience.

So you can imagine how proud we are that this commitment is something highly valued by members of our Riviera "family" of owners too.

With exclusive invitations to special adventures, social events and educational workshops, the "Riviera Experience" runs much deeper than owning a striking, sophisticated and stylish boat which not only looks a cut above the rest but also delivers in terms of superior sea-handling and innovative on-board technology.

Perhaps our passion is best reflected in the words of our Riviera owners:

*"I had not even turned the key on my new 445 and I already felt part of the Riviera family. I've owned a number of boats and maybe I'm a slow learner ... I should have bought a Riviera earlier!"*

*"We really enjoy coming together as the Riviera community. We've been on a couple of the Experience trips and there's a real safety aspect of going offshore and being around other Riviera owners, who know their boats and your boat too."*

And one more ...

*"Riviera goes over and above all expectations to make sure owners enjoy a great experience for the entire life of their boats. That lifelong commitment is something that really makes a difference."*

Yes, they are glowing endorsements and they are all from long-time Riviera owners who share something truly unique – they share the truly unrivalled "Riviera Experience".



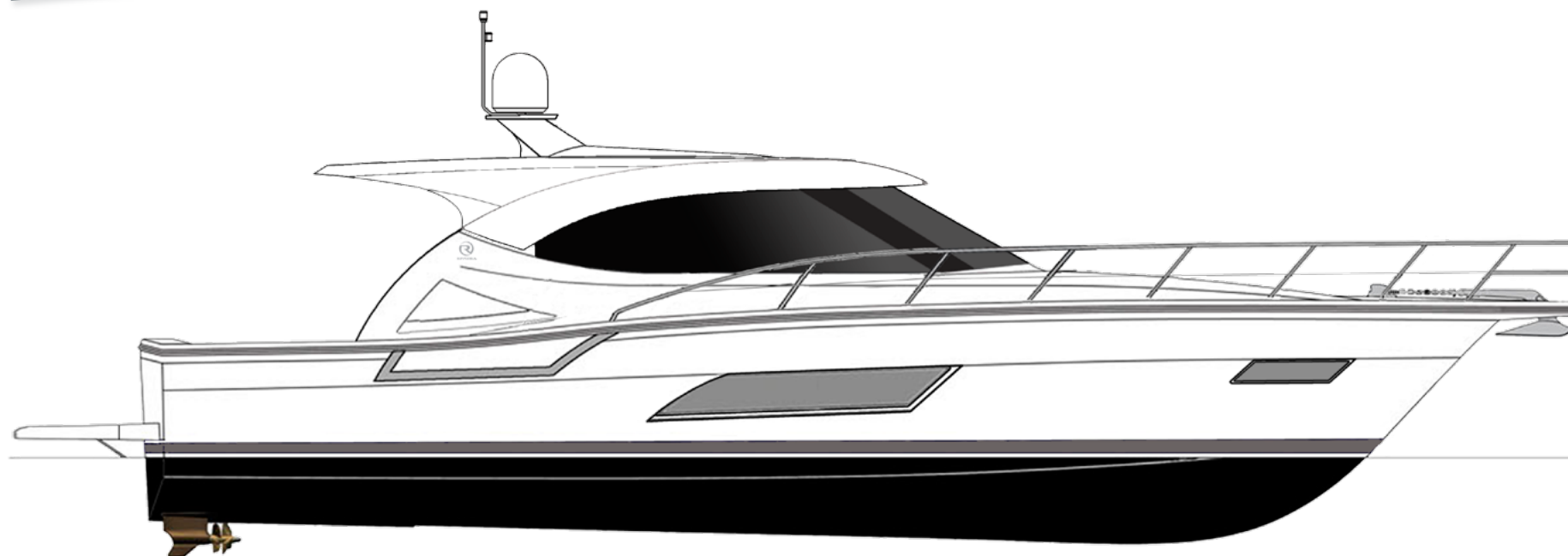

## 445 SUV

### SPECIFICATIONS

Length Overall (inc. swim platform and bow sprit)	14.46 m	47' 5"
Lh to ISO8666 *	13.61 m	44' 8"
Beam (inc. gunwale)	4.57 m	15' 0"
Maximum Draft (inc. props) (approx. depends on engines and options)	1.13 m	3' 8"
Dry Weight ** (approx.)	13,500 kg	29,800 lb
Fuel Capacity ***	2,000 L	528 US gal
Water Capacity	460 L	122 US gal
Holding Tank Capacity	151 L	40 US gal
Sleeping Capacity	6 persons	
Cockpit Area	11.42 m <sup>2</sup>	122.9 ft <sup>2</sup>
Bridge Clearance	3.27 m	10' 9"
Standard Engine – Volvo IPS600 D6 x 2	320 kW	435 hp each

#### Riviera Clarification of Specification

\*Length of the hull (Lh) to ISO8666: Includes all structural and integral parts (ie. the moulded length of the hull). It excludes parts that can be removed in a non-destructive manner without affecting the structural integrity of the craft, eg. pulpits, outdrives, driving platforms, rubbing strakes.

\*\*Dry weight represents the estimated minimum weight of a boat with standard engines and options, no fuel or water on board, no equipment or provisions and no personnel. The stated dry weight may be exceeded.

\*\*\*Denotes net tank capacity. For useable capacity do not rely on more than 90% of tank capacity. Actual capacity will vary according to boat trim and sea state.

Speeds are subject to normal weather conditions, fuel and/or water levels, passengers and equipment loads.

Refer to your Riviera Owner's Manual and your Dealer for height to hardtop and maximum height details.

The specifications in this document are not complete or definitive and are subject to change without notice and therefore may not be current. Riviera will not be liable (in contract, tort or otherwise) for any loss resulting from the inaccuracy of any information contained in this document.

Specifications may vary on a regional basis. Some images in this brochure may include non-standard or after-market options.

#### Warnings

Riviera is committed to building the best luxury cruisers, tailored to suit specific countries and their individual compliance laws and regulations. Riviera equipment and build specifications approved for one country may not be compliant with another country's safety and equipment regulations and as such those cruisers may have no recourse to Riviera extensive manufacturer's warranties.

Each country and State has different safety equipment standards.

It is important that you ensure the requirements in your jurisdiction are met prior to the vessel being used.



Our PASSION  
To create the *ultimate*  
boating experience.

